



**Montana**

**PANTON WIRE**

**MONTANA ACADEMY**

# Shared visions

When Peter J. Lassen, the founder of Montana, first met the young Danish architect Verner Panton in 1956, neither of them was aware that this would be the beginning of a close friendship and life-long collaboration.

The strong bond and shared history between Verner Panton and Peter J. Lassen has made it a natural choice for Montana to manufacture several of Verner Panton's designs.



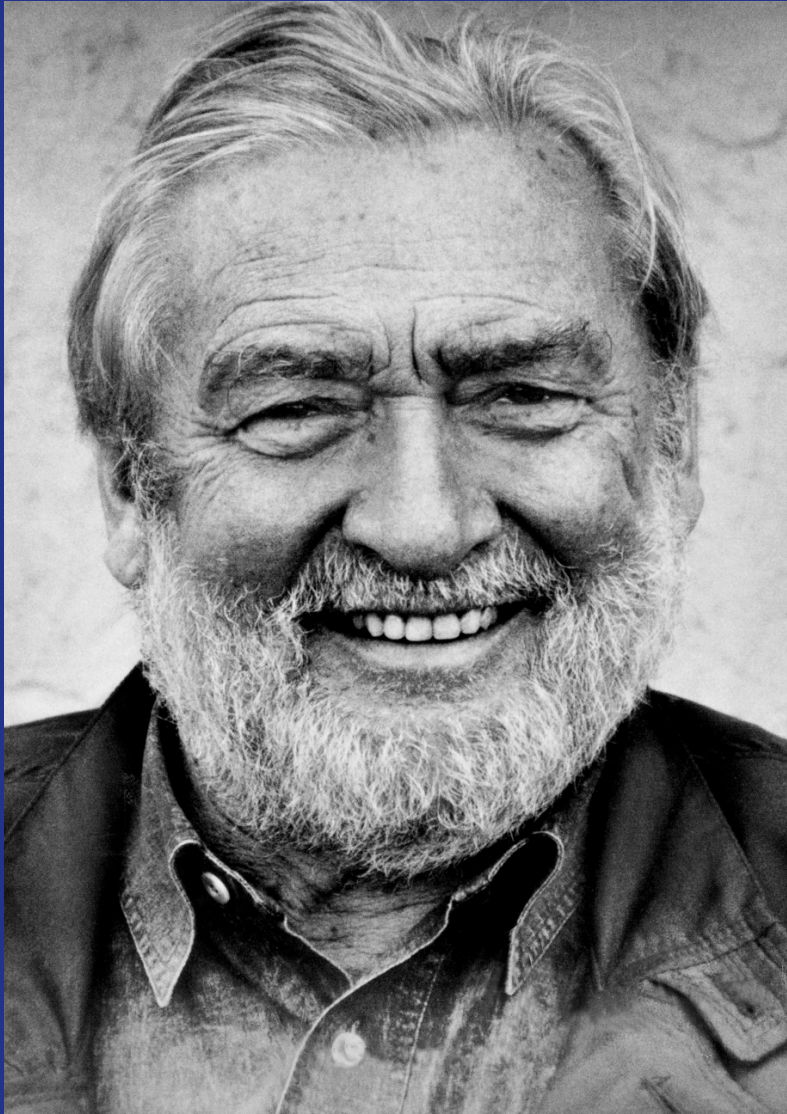

## A life in colours

Verner Panton (1926–1998) is regarded as one of Denmark's most influential 20th-century furniture and interior designers. He is celebrated for his persistent use of bold colours and organic shapes, as well as his groundbreaking use of materials and, for its time, innovative approaches to industrial furniture production methods.

Panton is synonymous with vibrant colours and fluid, organic forms. However, during his collaboration with Peter Lassen in the 1970s, he also showcased an impressive approach to system thinking.

Throughout his career, Panton created innovative and futuristic designs using a variety of materials, particularly plastics and steel, and always embraced vibrant, dynamic colour schemes.

# Panton Wire

A versatile shelving system designed by Verner Panton in 1971.

Use Panton Wire next to the bed or the sofa, as a light room divider – or hang the units on the wall.

The modules invite an infinite number of combinations and can be used everywhere: At home, in the store, as a bookshelf, in the bathroom.





## PANTON WIRE

Marble top plate is available for Pantan Wire



## PANTON WIRE

Panton Wire in Black Red with Monarch top plate

## 2 Heights

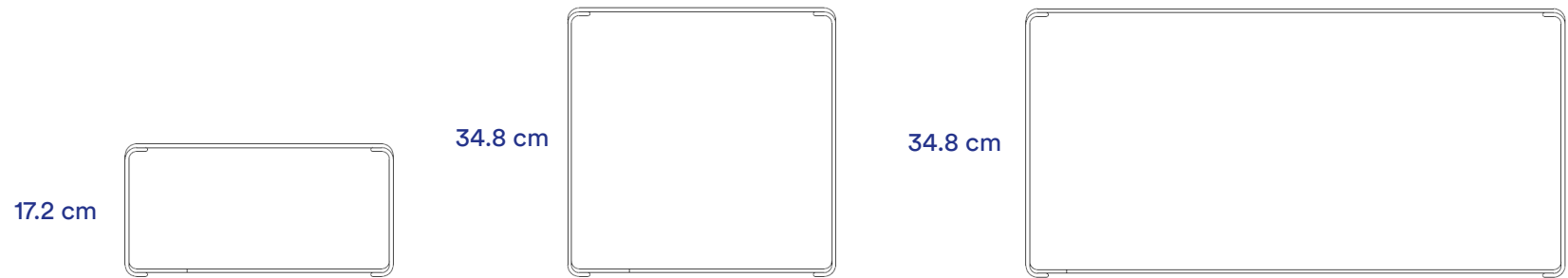

## 2 Depths

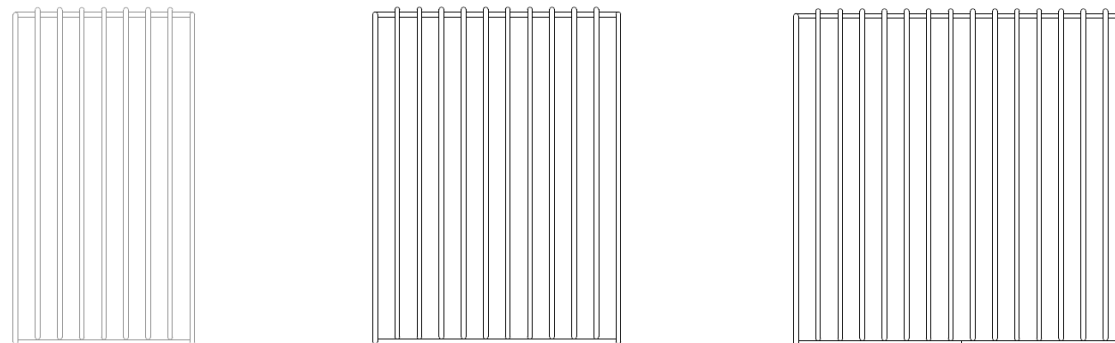

18.8 cm\*

25.7 cm

34.8 cm

\*Depth 18.8 cm will be discontinued when stock is sold out

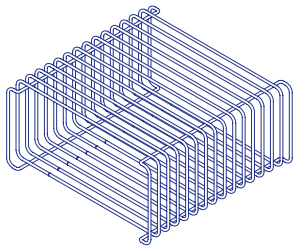

**7661T D35**  
H 17.2 cm / W 34.8 cm / D 34.8 cm

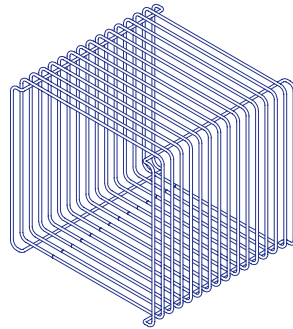

**6161T D35**  
H 34.8 cm / W 34.8 cm / D 34.8 cm

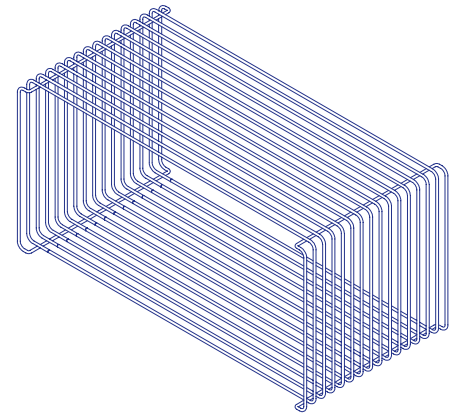

**6111T D35**  
H 34.8 cm / W 70 cm / D 34.8 cm

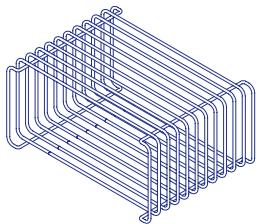

**7661T D26**  
H 17.2cm / W 34.8 cm / D 25.7 cm

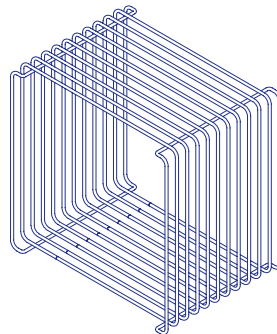

**6161T D26**  
H 34.8 cm / W 34.8 cm / D 25.7 cm

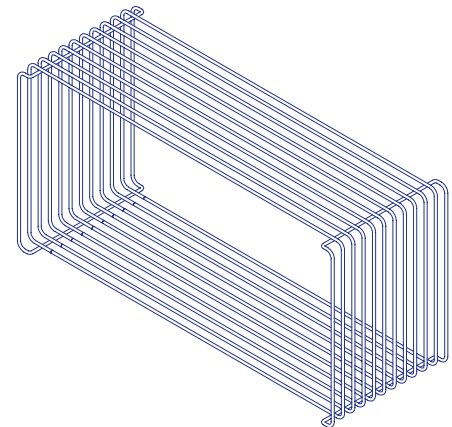

**6111T D26**  
H 34.8 cm / W 70 cm / D 25.7 cm



## Panton Wire



43  
Chrome



05  
Black

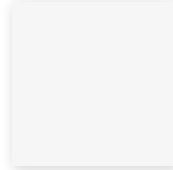

38  
Snow



136  
Pine



135  
Monarch



07  
Black Red



145  
Rosehip



## Top panels



992  
White Marble



995  
Black Marble



05  
Black



101  
New White



136  
Pine



135  
Monarch



07  
Black Red



145  
Rosehip

## Inlay shelves



05  
Black



101  
New White



136  
Pine



135  
Monarch



07  
Black Red



145  
Rosehip



-  
Clear glass



## PANTON WIRE

Panton Wire is always delivered with both suspension and feet

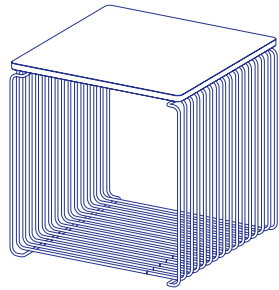

Top panel

Height: 1.2 cm  
Width: 34.8 cm  
Depth: 34.8 cm

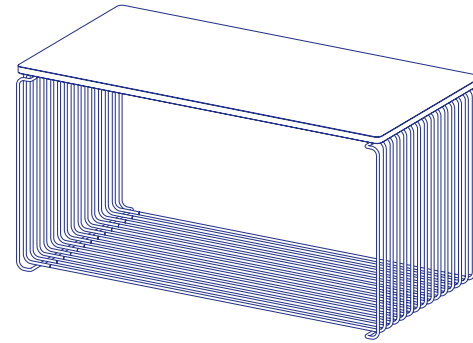

Top panel

Height: 1.2 cm  
Width: 70.1 cm  
Depth: 34.8 cm

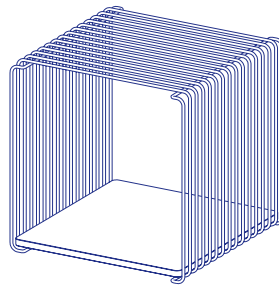

Inlay shelf

Height: 1.2 cm  
Width: 33 cm  
Depth: 34.8 cm

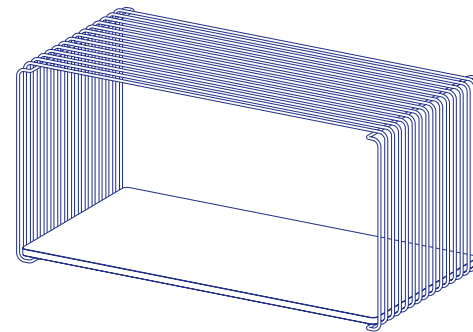

Inlay shelf

Height: 1.2 cm  
Width: 68.2 cm  
Depth: 34.8 cm



**PANTON WIRE**  
Depth 25.7 cm configuration

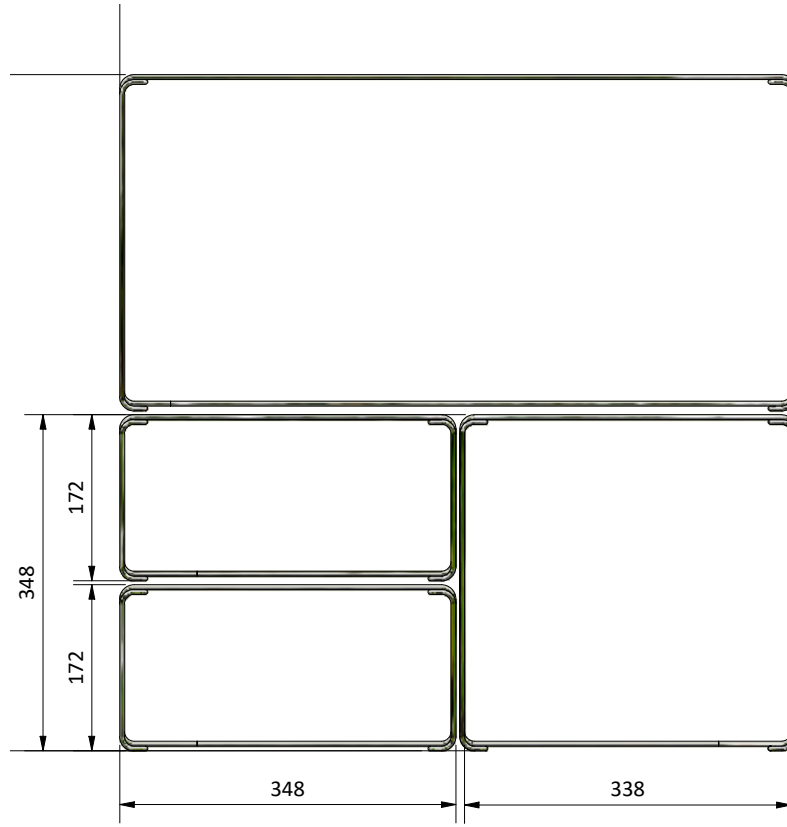

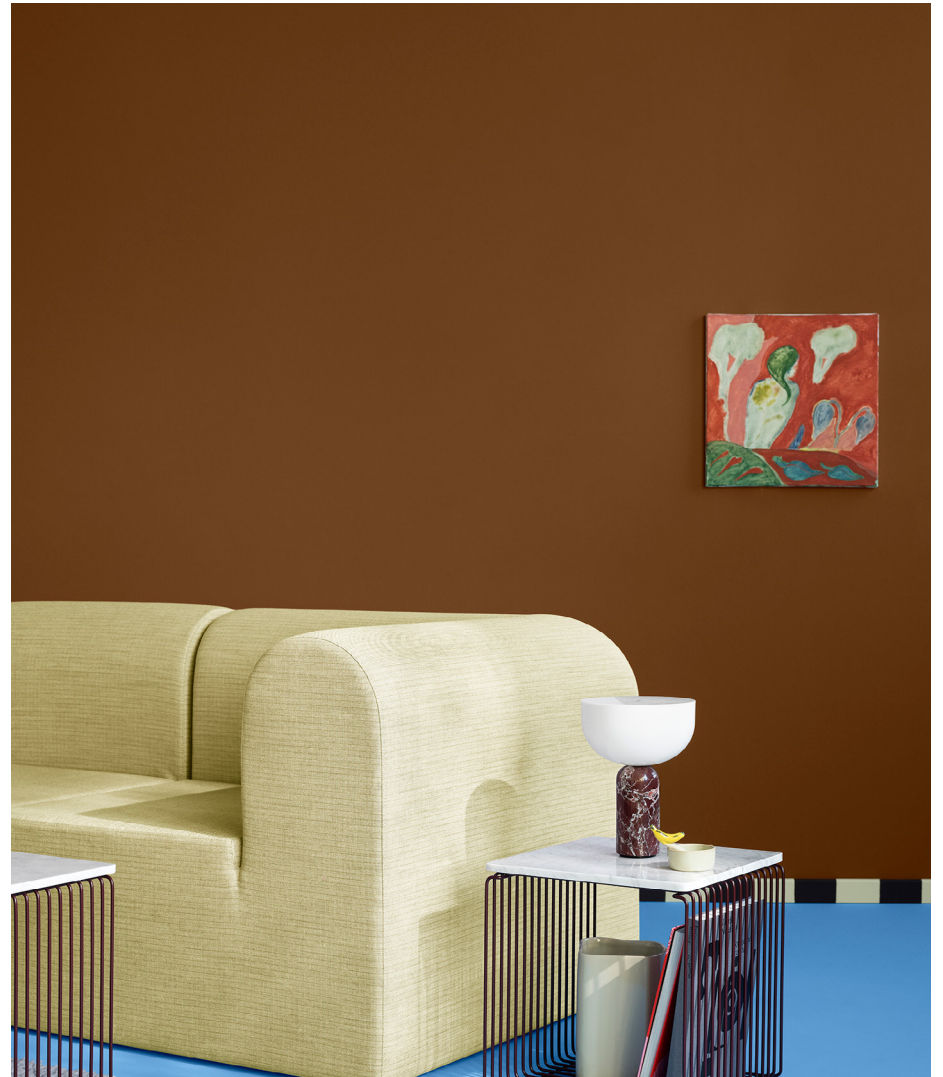

## PANTON WIRE

Marble top plate is available for Panton Wire



## Specifications

### Materials

Panton Wire is made from 5 mm steel.

### Components

Panton Wire is always supplied with feet and clips for joining, and two suspension brackets for wall mounting.

### Max load

Each unit can bear loads of up to 40 kg when standing on the floor and 10 kg when mounted on the wall.

### Stability

Modules higher than 70 cm must be secured to the wall with a security strip. All modules are delivered with one security strip.



**PANTON WIRE**  
Panton Wire in Black Red



# EU Ecolabel

The EU Ecolabel is a label of environmental excellence. Recognized across Europe and worldwide.

Awarded to products that meet high environmental standards throughout their life cycle. Less waste and less CO<sub>2</sub> during production. Durable, easy to repair and recyclable quality and design.

The EU Ecolabel provides exigent guidelines and offers third party controls and audits.



**Montana**